

PUD : CENTRU MEDICAL AMBULATORIU / SEDIU FIRMA
MUNICIPIUL PLOIESTI, STRADA LIBERTATII F.N., TARLA
527, PARCELA A18 LOT2, JUDETUL PRAHOVA

INCADRARE IN TERITORIU

*Copie conforma cu originalul din
arhivă 8680
Sc 1:5000
Serviciul Cadastral si Carti*

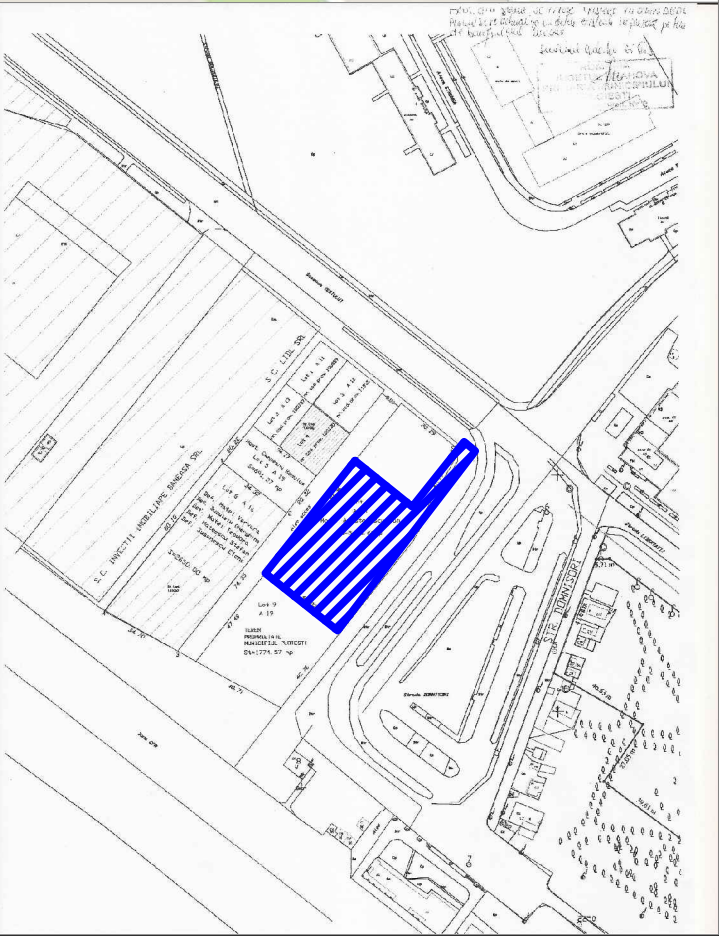
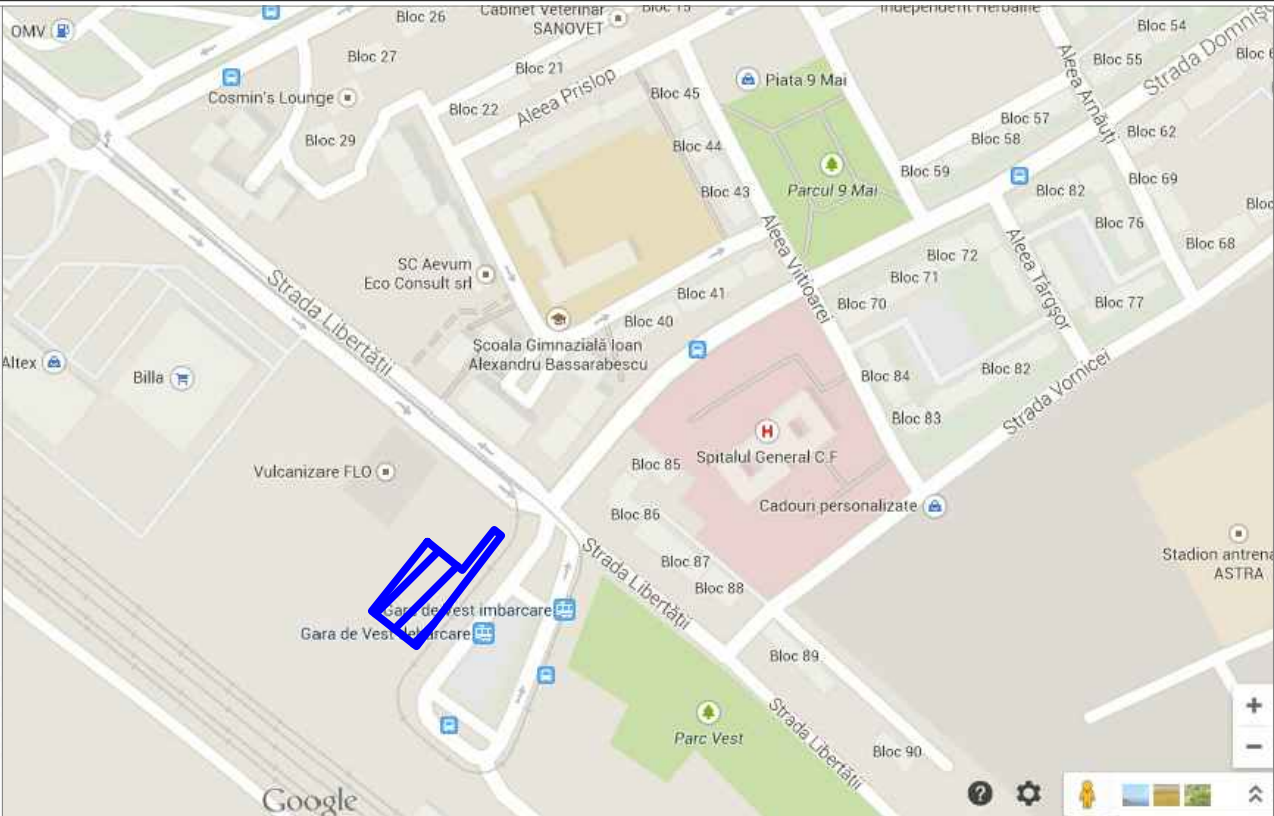
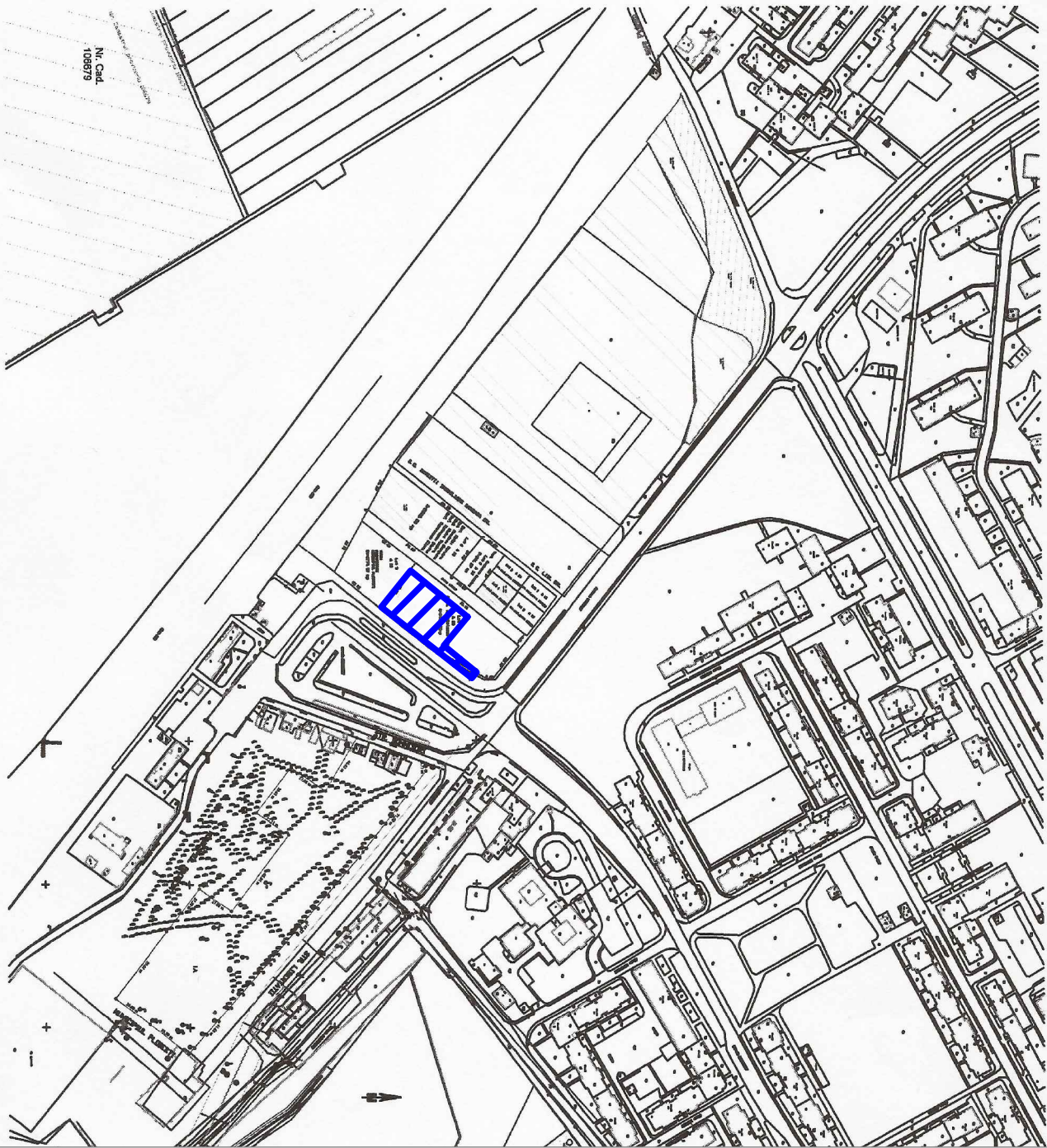

LEGENDA
LIMITA TEREN

ARHITECTURA PLUS		CONSTANTA, STR. MARC AUELIU, NR. 15	
TITLU: CENTRU MEDICAL AMBULATORIU / SEDIU FIRMA, BRANSAMENTE UTILITATI			faza
LOCALIZARE: MUNICIPIUL PLOIESTI, STRADA LIBERTATII, TARLA 527, PARCELA A18 LOT 2,			C.U.
BENEFICIAR : PRIMAPHARM LIFE SCIENCE SRL			CTR. NR.
VERIFICAT: ARH. DAN DILANCEA		scara - -	PLAN DE INCADRARE IN TERITORIU
PROIECTAT: ARH. GABRIELA VASILESCU		FEB. 2014	
			U01